







PRICED AT  
**\$1,022,870**

-  2117 Sq Ft
-  3 Beds
-  3.5 Baths
-  2 Car Garage
-  3.0 Story

Best Lot overlooking Thompson Street Park! Home Site 41 is a **MUST SEE!** Spring into a New Home & \$5,000 Towards Closing Cost with 1 of our 5 Preferred Lenders! Modern & Luxury Finishes paired with Downtown Alpharetta easy living will make you fall in love with your New Construction Home! Home Site 41 is an End Unit looking directly over Thompson Street Park! The home site is a must see! Having the largest front yard, guests enter directly from Thompson Street sidewalk into your grand foyer. Wall trim details the stairwell going to the main living level while French Doors to the right lead to your terrace level bedroom. Oversized Terrace Level bedroom offers 2 oversized, 7 ft. windows providing ample natural light plus a full bathroom with a walk-in shower. The Main Level features additional side windows providing gorgeous views of Thompson Street Park as you kitchen prep. The Cabinetry to the ceiling plus additional cabinet storage on the back side of the 9 ft island provides ample storage space. Sleek Quartz countertops continue from the elegant waterfall island to the Backsplash creating quiet the statement. Light colored oak floors provide a complementary contrast as you peer into ...

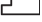
**Want to Know More  
About This Home?**

CONTACT OUR COMMUNITY SALES MANAGER  
Call Us @ 470-248-2777

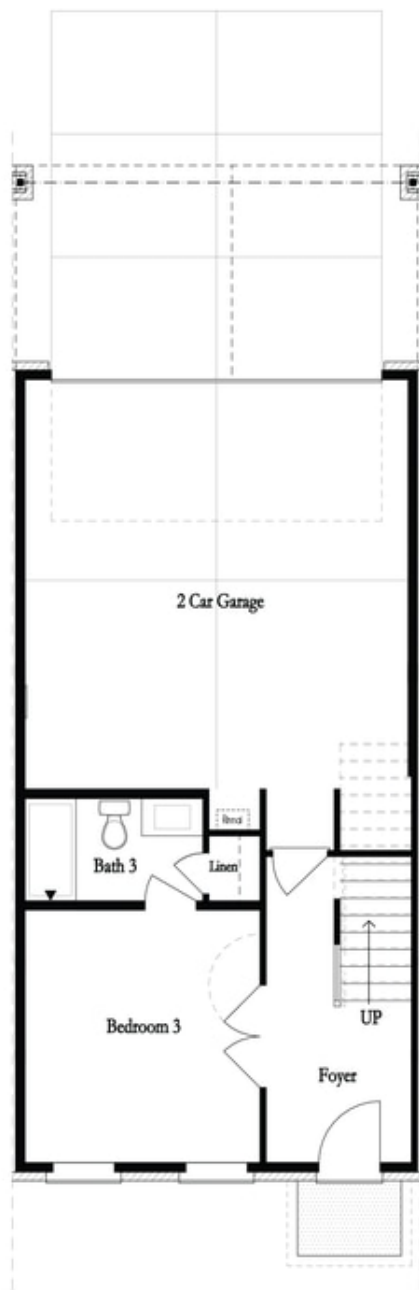

**Want to Know More  
About This Home?**

CONTACT OUR COMMUNITY SALES MANAGER  
Call Us @ 470-248-2777

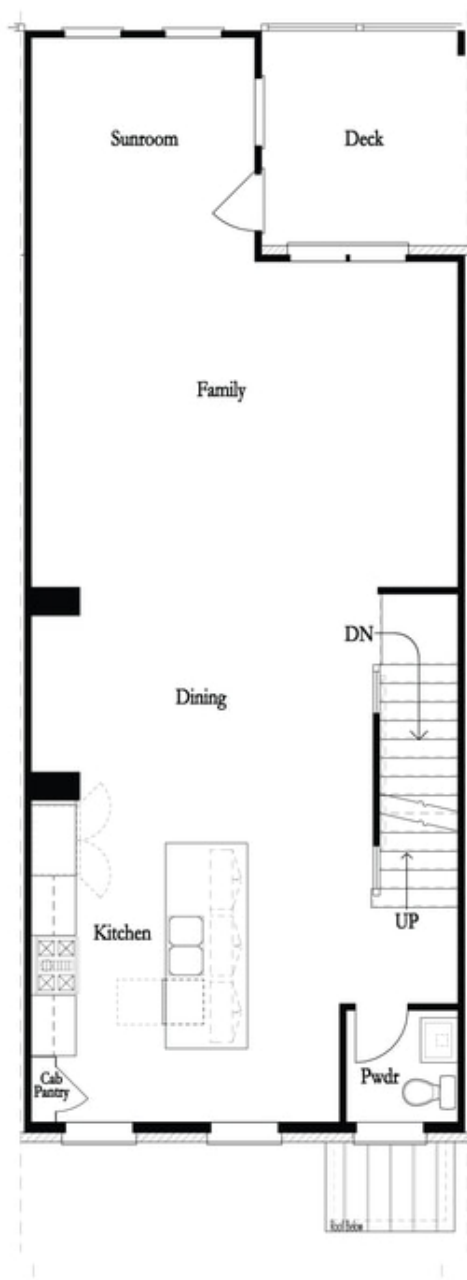

**Want to Know More  
About This Home?**

CONTACT OUR COMMUNITY SALES MANAGER  
Call Us @ 470-248-2777

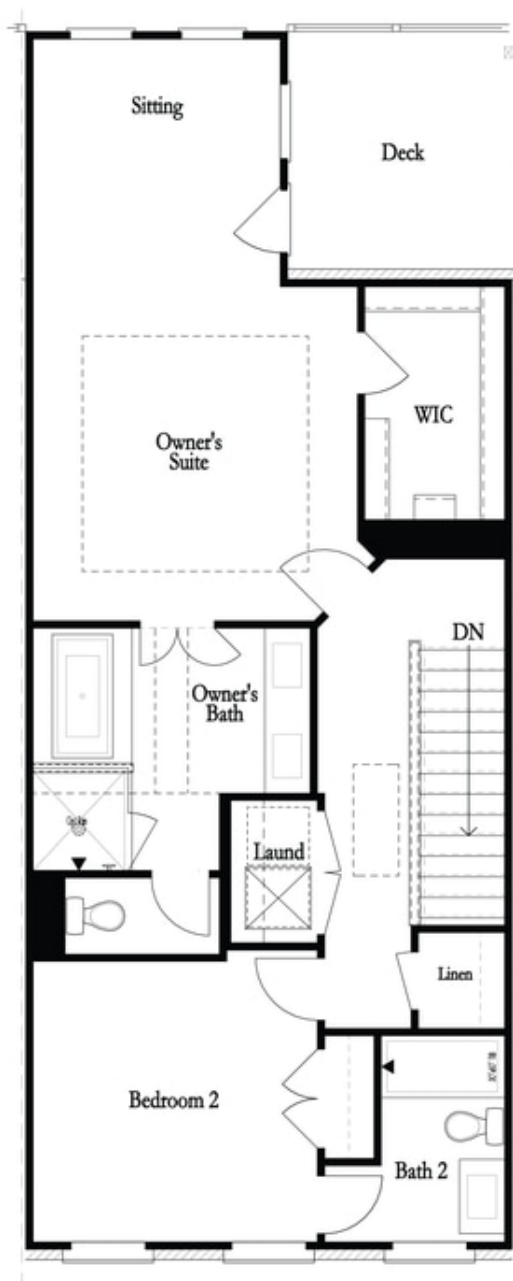

**Want to Know More  
About This Home?**

CONTACT OUR COMMUNITY SALES MANAGER  
Call Us @ 470-248-2777

### Options

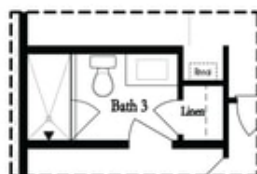

Optional Shower

### First Floor Options

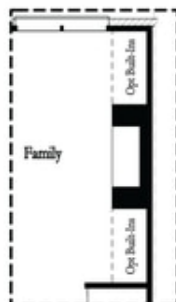

Optional Fireplace  
Linear

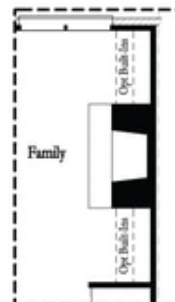

Optional Fireplace

### Second Floor Options

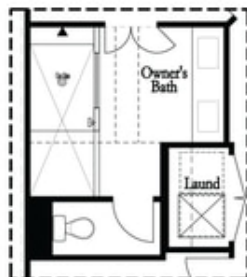

Optional Walk Through Shower



Optional Freestanding  
Tub / Shower Combo

### Third Floor Options

**Want to Know More  
About This Home?**

CONTACT OUR COMMUNITY SALES MANAGER  
Call Us @ 470-248-2777