



PRICED AT
\$513,400

 2004 Sq Ft

 3 Beds

 3.5 Baths

 2 Car Garage

 3.0 Story

Spring into a New Home!! Are looking for a home in a great location, convenient to GA 400, retail shops, restaurants, the City Center and the lake? AND A QUICK MOVE-IN???? Well, look no further!! Located in Cumming, GA, the Brackley is TPG's newest community with our Glendale Townhomes ready for a quick move-in!! This building will be ready for a May-June move-in...so just bring your belongings and call Brackley home! This 2004 square foot townhome will have 3 fabulous bedrooms each with their own ensuite for ultimate privacy. When you enter the terrace level, you will have a convenient bedroom with full bath, or maybe you need this space as a home office. You will have a rear entry garage on this floor as well. As you ascend upstairs, you will be amazed at the expansive space!! Bright and open, you will have numerous windows that let the light pour in! The family room will also have a sunroom great for another living space, office or just a great reading nook. The kitchen finishes in this home will make you want to become a cook if you aren't already! Stainless steel GE appliances, under cabinet lighting, soft touch drawers ...

**Want to Know More
About This Home?**

CONTACT OUR COMMUNITY SALES MANAGER
Call Us @ 470-509-9930



**Want to Know More
About This Home?**

CONTACT OUR COMMUNITY SALES MANAGER
Call Us @ 470-509-9930



Optional Bath 3 Shower ilo Tub



Optional Owner's Luxury Shower

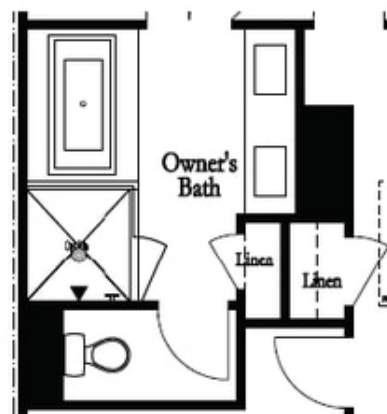

Optional Owner's Shower & Tub



Optional
Family Room
Fireplace

Optional
Family Room
Linear Fireplace



Optional Sunroom 1 ilo Extended Deck

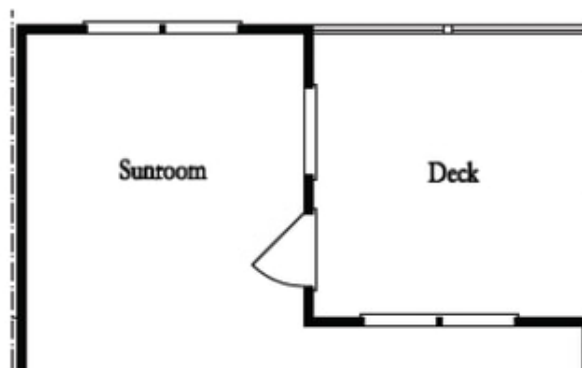

Optional Sunroom 2 ilo Extended Deck

**Want to Know More
About This Home?**

CONTACT OUR COMMUNITY SALES MANAGER
Call Us @ 470-509-9930