



PRICED AT
\$560,100

 2004 Sq Ft

 3 Beds

 3.5 Baths

 2 Car Garage

 3.0 Story

New Year, New Home, New You! QUICK MOVE-IN! \$10,000 towards closing costs when financing with one of the Seller's preferred lenders on contracts written in February! Enjoy beautiful views from this stunning 3-story Glendale plan! Overlooking open, professionally landscaped green space, this home feels like a breath of fresh air. Located in a highly sought-after neighborhood - just minutes from Suwanee Town Center, Downtown Duluth, Buford & more! The community offers a range of amenities, such as a gated entrance, clubhouse, pool, playground, five charming pocket parks, and direct access to Peachtree Ridge Park! Entry level includes a private bedroom with a full bath. The main level's open concept design seamlessly connects the kitchen to the dining area and living room, creating a spacious and inviting living space. The beautifully designed kitchen features upgraded finishes such as modern, white cabinets with soft close doors & under-cabinet lighting, sleek quartz countertops, & stainless steel appliances. The living room & sunroom include large windows flood the area with natural light, creating a warm and welcoming atmosphere. On the upper level you will find your owner's suite featuring a spa-like bathroom complete with a separate tub & shower, linen closet, & dual vanities. ...

**Want to Know More
About This Home?**

CONTACT OUR COMMUNITY SALES MANAGER
Call Us @ 470.456.9551



**Want to Know More
About This Home?**

CONTACT OUR COMMUNITY SALES MANAGER
Call Us @ 470.456.9551



Optional Bath 3 Shower ilo Tub



Optional Owner's Luxury Shower

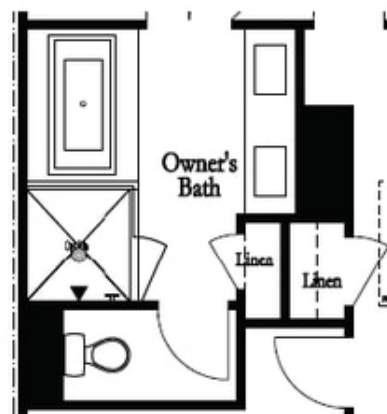

Optional Owner's Shower & Tub



Optional
Family Room
Fireplace

Optional
Family Room
Linear Fireplace



Optional Sunroom 1 ilo Extended Deck

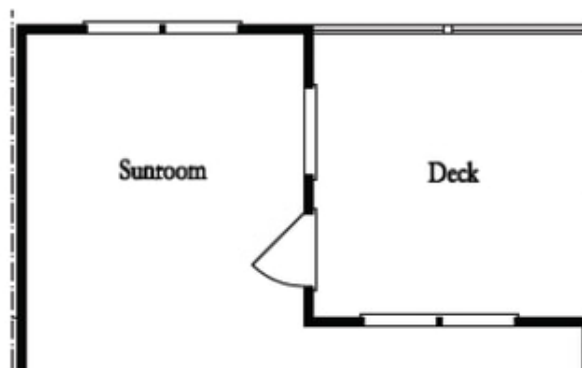

Optional Sunroom 2 ilo Extended Deck

**Want to Know More
About This Home?**

CONTACT OUR COMMUNITY SALES MANAGER
Call Us @ 470.456.9551