



PRICED AT  
**\$563,900**

 **2004 Sq Ft**

 **3 Beds**

 **3.5 Baths**

 **2 Car Garage**

 **3.0 Story**

Spring into New Home! QUICK MOVE-IN! \$5,000 towards closing costs when financing with one of the Seller's preferred lenders! Enjoy beautiful views from this stunning 3-story Glendale plan! Located in a highly sought-after neighborhood - just minutes from Suwanee Town Center, Downtown Duluth, Buford & more! The community offers a range of amenities, such as a gated entrance, clubhouse, pool, playground, five charming pocket parks, and direct access to Peachtree Ridge Park! Entry level includes a private bedroom with a full bath. The main level's open concept design seamlessly connects the kitchen to the dining area and living room, creating a spacious and inviting living space. The beautifully designed kitchen features upgraded finishes such as modern, white cabinets with soft close doors & under-cabinet lighting, sleek quartz countertops, & stainless steel appliances. The living room & sunroom include large windows flood the area with natural light, creating a warm and welcoming atmosphere. On the upper level you will find your owner's suite featuring a spa-like bathroom complete with walk-in shower, linen closet, & dual vanities. A secondary bedroom with its private bath is situated further down the hallway, and you'll appreciate the practicality of having the laundry area conveniently located ...

**Want to Know More  
About This Home?**

CONTACT OUR COMMUNITY SALES MANAGER  
Call Us @ 470.456.9551



Want to Know More  
About This Home?

CONTACT OUR COMMUNITY SALES MANAGER  
Call Us @ 470.456.9551



Optional Bath 3 Shower ilo Tub



Optional Owner's Luxury Shower

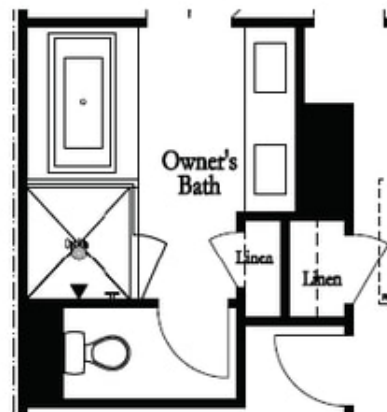

Optional Owner's Shower & Tub



Optional  
Family Room  
Fireplace

Optional  
Family Room  
Linear Fireplace



Optional Sunroom 1 ilo Extended Deck

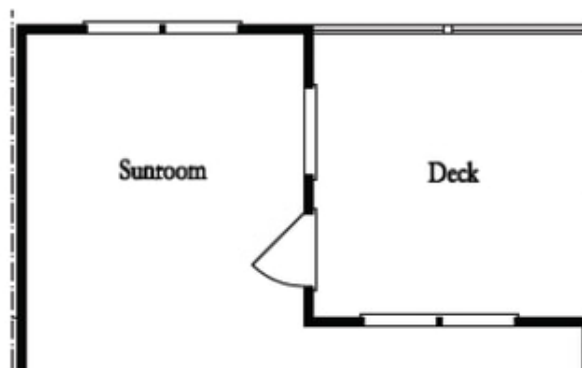

Optional Sunroom 2 ilo Extended Deck

Want to Know More  
About This Home?

CONTACT OUR COMMUNITY SALES MANAGER  
Call Us @ 470.456.9551