



PRICED AT  
**\$586,800**

 2004 Sq Ft

 3 Beds

 3.5 Baths

 2 Car Garage

 3.0 Story

Spring into a New Home! Don't miss an opportunity to purchase this light filled END UNIT Glendale at Ellington! This desirable layout offers a private bedroom on the terrace level with a full Bath. Open concept on main floor makes entertaining easy. Light filled Kitchen with gleaming floors, oversized Quartz Island and stainless steel appliances opens to Dining Room that can comfortably seat all your guests. Family room with cozy Gas Fireplace leads into bright Sunroom that can be used as a separate designated Office space or Lounge area that connects to your private Deck. On the upper level you will find your Owner Suite with huge Walk-in Closet and Spa-like Bath featuring walk-in Shower, soaking Tub & separate vanities. Laundry Room conveniently located on the same level as Owner's suite. Both secondary bedrooms come with full bath and can easily accommodate work from home office space and/or multi generational living. Community amenities include a gated entrance, clubhouse, pool, five pocket parks and paved walkway to Peachtree Ridge Park! Highly rated Schools, Shopping, Dining, Parks and Trails all within close proximity. Purchase this beautiful Quick Move-in with \$5,000 towards Closing Costs and/or pre-pays when using a preferred lender for your ...

**Want to Know More  
About This Home?**

CONTACT OUR COMMUNITY SALES MANAGER  
Call Us @ 470.456.9551



**Want to Know More  
About This Home?**

CONTACT OUR COMMUNITY SALES MANAGER  
Call Us @ 470.456.9551

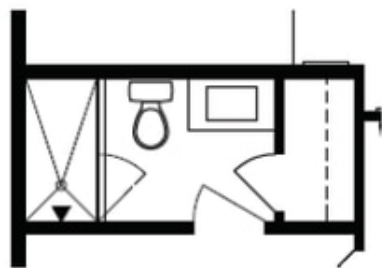

Optional Bath 3 Shower ilo Tub



Optional Owner's Luxury Shower

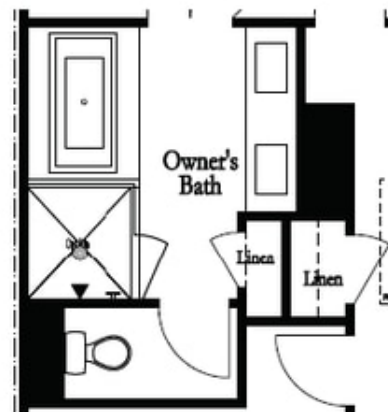

Optional Owner's Shower & Tub

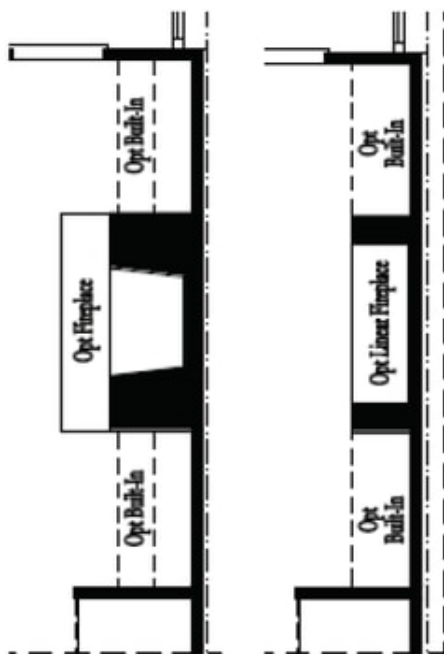

Optional  
Family Room  
Fireplace

Optional  
Family Room  
Linear Fireplace

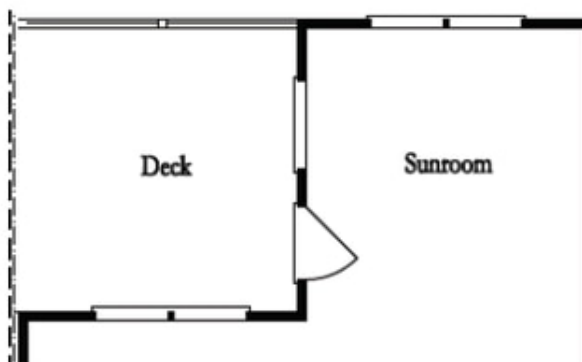

Optional Sunroom 1 ilo Extended Deck

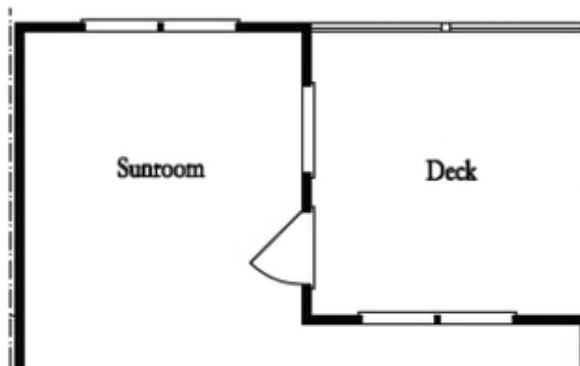

Optional Sunroom 2 ilo Extended Deck

**Want to Know More  
About This Home?**

CONTACT OUR COMMUNITY SALES MANAGER  
Call Us @ 470.456.9551